

OPTICAL FIBRE SWITCH For Tachometer Applications

- High speed Opto-Fibre sensor switch
- Interference-free
- Contact-less
- New Glass fibre probes
- Square wave output signal
- Engine test benches
- Rotation speed analysis
- Combustion Analysis
- Vibrations Analysis
- Engine Manufacturers
- Formula One development
- Environmental test chambers

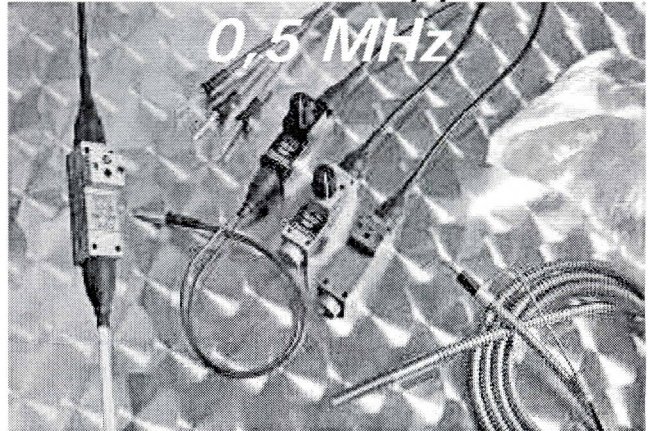

TECHNICAL CHARACTERISTICS

RANGE

Diffuse reflection $D = f(\text{encoding}) = f(\text{albedo})$
Through-beam

ELECTRICAL SPECIFICATIONS

Transmitter

Receiver (sensible to the light)

Output: 5V square wave signal

Supply Voltage

Current Consumption 120mA with 12Vcc

*Connection don't extend the 1.5M longer cable to avoid noise and increase the form of the signal

Frequency
receiver theoretical response (20% to 85% measured form)

Output control

Amplifier's Temperature (Dry conditions)

Electrical Protection

Power Adjustment

MECHANICAL SPECIFICATIONS

Box

Mass

Shape and setting

OPTICAL PROBES

Through-beam probes / *slit ending fibre probe*

Diffuse reflection / *slit ending fibre probe*

Temperature Range*

*high θ probe

Objectives lens micro-optic on top

Phonic wheel/ Sticky-backed encoders

Ending probes

Other Sensor for speed measurement

CONTACTS:

+33 148.575.833 - Fax +33.142.870.088

MINIMAL INVASIVE SENSING!©

152 G8

Recommended range

1mm < D < 5mm (Black and White)

20mm/30mm + micro-optic / 60mm + objective

LED IR

High-speed component

PNP/ I_{max}:30mA/ form:  5VCC

12 Vcc

1.5 m cable*

give preference to long fibre probes

0 < F < 0,5 Megahertz
Rise time = Fall time = 5 to 25 nanosecond.

Yellow DEL

From -10 °C To +50 °C*

Temporary

3/4 tour Potentiometer

AU4G Anodized, standard in black

150 g

14X48mm, Hole Ø 3mm

MultiFFO / *Multi SLIT FFO*

MultiYO / *Multi SLIT YO*

From -50 °C to +120 °C

On Specification up to 200 °C

On Specification

Y / FF / TBY / TBFF / threaded / SLIT

152 G6-152G7-152G10-152G14-152 G16

info@optel-thevon.fr www.optel-thevon.fr

Factory: 104 RUE DE ROSNY 93100 MONTREUIL France

AGILE IN EVERY SENSE!©

Probe separately sold
MULTI SLIT YO HM6x15

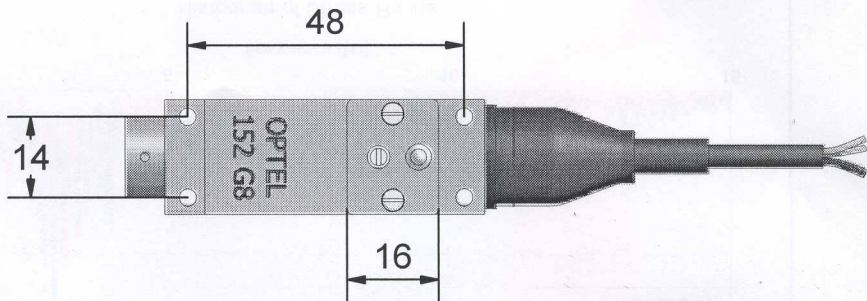
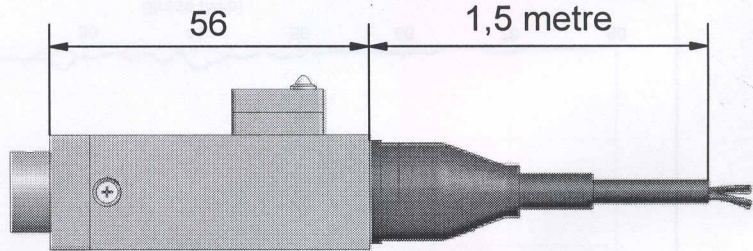
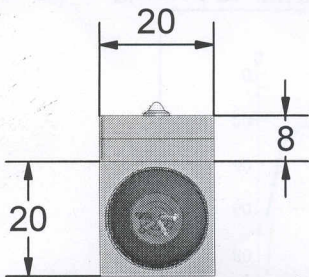
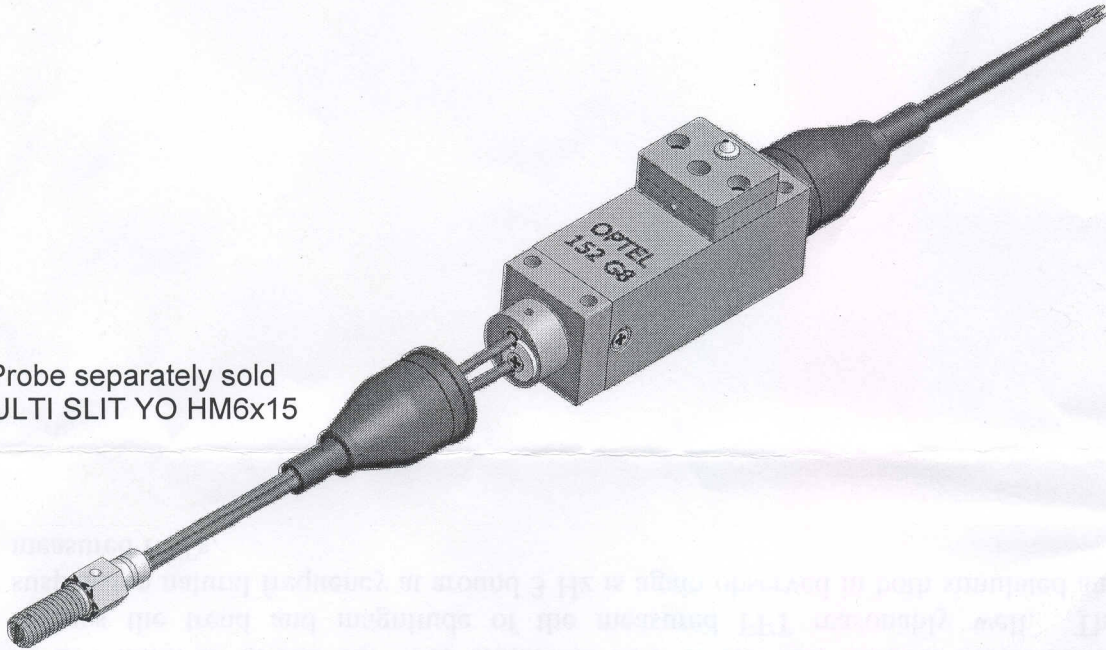

The characteristics here are r.o.t of contractual matters. OPTTEL-THEVON keeps the right to proceed to alterations or improvements without any previous notice.



OPTTEL THEVON
104 Rue de Rosny
F- 93 100 MONTREUIL
Tél : +33(0) 148 575 833
Fax : +33(0) 142 870 088
info@optel-thevon.fr
www.optel-thevon.fr

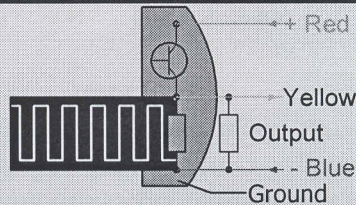

Put together the blue and bared wire to improve the ground.

Add a load user $\approx 1K\Omega$ for a better output signal.

Material
Anodized aluminium

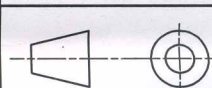

Date
25/ 09 / 08

Reference
152 G8

